



ULTIMATE OVERBATH SHOWER PANEL

Installation Instructions

Please read these instructions before installing, as incorrect fitting will invalidate the guarantee.
 If you are unsure about these instructions please contact
 Kudos Shower Products
Customer Service Helpline: 01539 564040

TOOLS REQUIRED

- | | |
|------------------------|-----------------------|
| Electric drill | Tape measure |
| 7mm masonry drill | Hacksaw |
| Pozi-drive screwdriver | Allen keys (supplied) |
| Spirit level | Silicone Sealant |

IMPORTANT

Check appearance of Shower Panel.
 Any defects must be reported to Kudos Shower Products before assembly/ installation. Claims for imperfections will only be accepted prior to assembly/ installation

Ensure bath is level in **all** directions

Waterproof walls using ceramic tiles/ shower panels etc., **before** installing bathscreen

Care should be taken when drilling into walls to avoid hidden pipes or electrical cables

Any gap or crevice between the rim of the bath and finished walls must be filled with silicone sealant flush with the rim of the bath **before** installing shower panel - see detail opposite

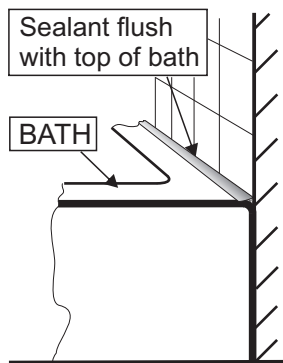

HANDING

HANDING THE PANEL - this shower panel is suitable for both left-hand and right-hand fitting, simply turn the panel around to suit your installation.

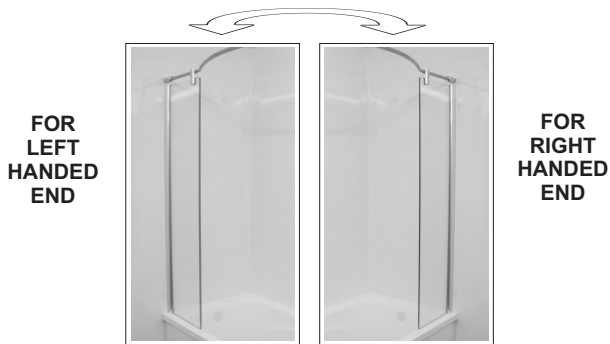

CLEANING

GENERAL - use only warm soapy water and damp cloth/ sponge on a regular basis.
 Do not use abrasive scouring powders, chemicals or aerosol cleaners - these may result in damage to the surfaces, in particular, the plated component parts

THESE INSTRUCTIONS ARE TO BE LEFT WITH THE USER

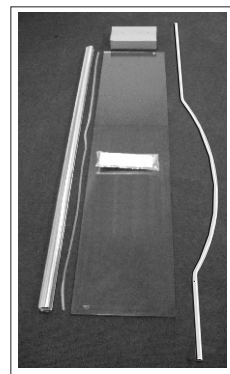

RECESS RAIL PACK

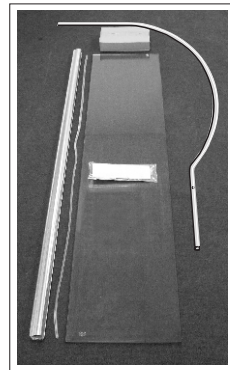

CORNER RAIL PACK

PACK CONTENTS

- Glass Panel
- Wallpost
- Component Pack
- Glazing Seal
- Stabiliser Rail-Recess or Corner
- Installation Pack

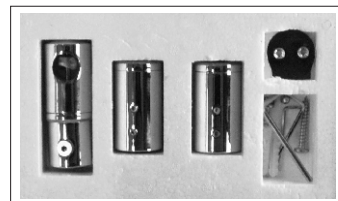

COMPONENT PACK - detail

1 REMOVE WALLPOST and glazing seal from glass panel.

2 POSITION WALLPOST onto bath so that glass panel will sit on inside edge of bath rim.

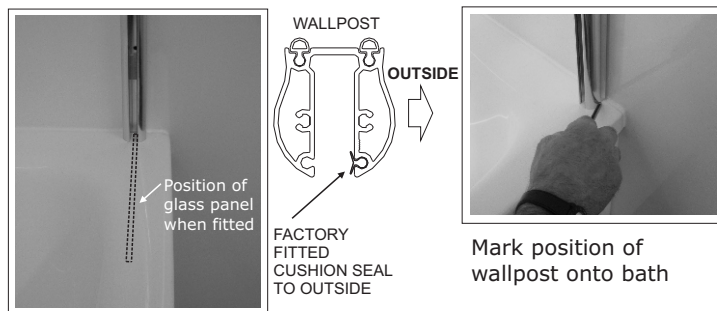

Mark position of wallpost onto bath

3 MARK through pre-drilled holes in wallpost, use spirit level to ensure wallpost is vertical.

Using 7mm drill bit, drill holes into wall and fix wallpost using rawlplugs and 30mm long screws provided.



INSTALLATION PACK



- 4 INSERT** glass panel into wallpost. Using spirit level to ensure glass panel is vertical, insert glazing seal to inside of wallpost to retain panel in place.



TIP If tight, lubricate glazing seal with water. Do not stretch seal when inserting, because, after cutting to length, the seal will shrink and leave a gap.

- 5 ALIGN** GLASS PANEL to ensure it is parallel with bath outer edge and wedge folded cardboard strip between panel and bath to retain in this position until top rail is fitted.

- 6 MARK** VERTICAL LINE on wall from CENTRELINE OF GLASS. Mark horizontal line 39mm from TOP EDGE of GLASS. This is the centre for the wall bracket body.

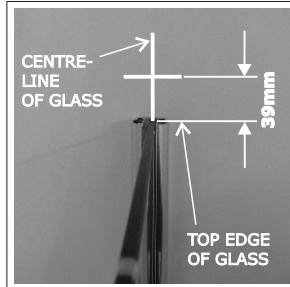

- 7 FIT** TOP COVER CAP from component box using two 10mm screws provided.

COVER CAP

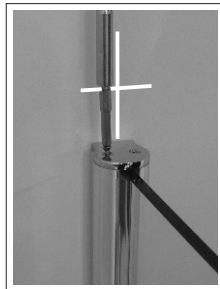
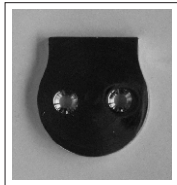

- 8 DRILL** HOLE in wall at intersection of drawn lines and fit rawlplug provided from the component pack.

- 9 FIT** WALL BRACKET BODY to wall using screw provided from component pack.

Separate body from shroud

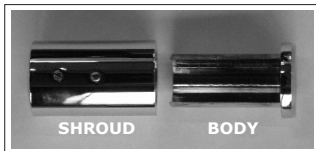

COMPONENT PACK



- 10 FIT** TOP FINIAL through hole in glass panel using 4mm allen key provided, ensuring screw is to inside and plastic sleeve is fitted to screw. Finger-tighten screw at this stage.

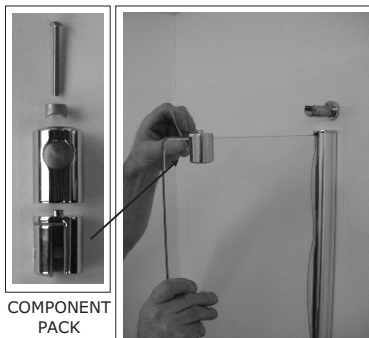

- 11 TRIM** TOP RAIL if required using hacksaw.

FOR CORNER RAIL

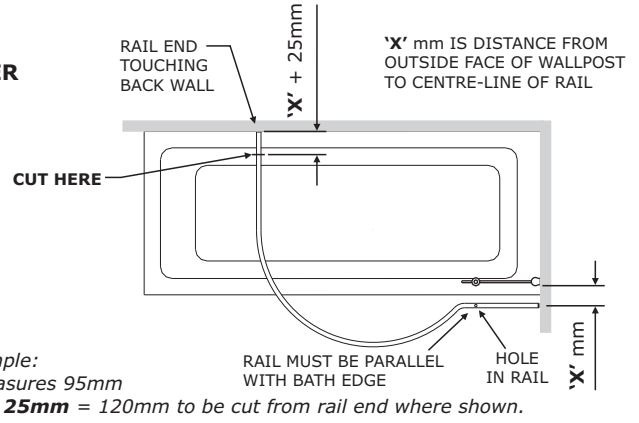

For example:
If 'X' measures 95mm
 $95\text{mm} + 25\text{mm} = 120\text{mm}$ to be cut from rail end where shown.

FOR RECESS RAIL

IMPORTANT
ALWAYS CUT RAIL AT OPPOSITE END OF HOLE IN RAIL

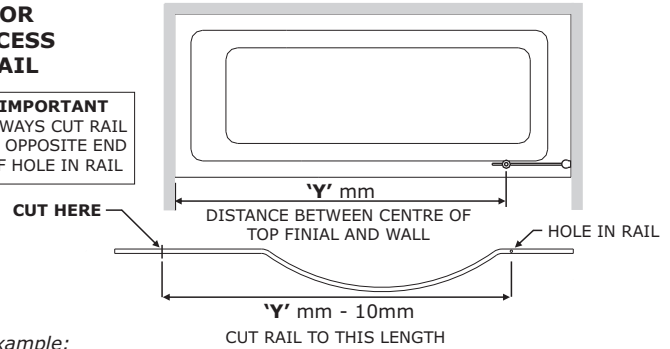

For example:
If 'Y' measures 1390mm
 $1390\text{mm} - 10\text{mm} = 1380\text{mm}$ finished cut length of rail **from hole centre**.

- 12 FIT** TOP RAIL - fit rail holder, shaped washer and screw through hole in rail. Slide shroud onto rail and fit to glass panel and wall bracket. Loosely tighten screws at this stage with allen keys.

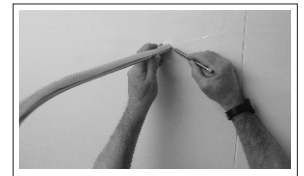

ENSURE RAIL IS LEVEL AND MARK POSITION ONTO WALL

- 13 DRILL** HOLE in wall and fit 2nd bracket body as described in stages 8 & 9. **FIT SHROUD** to rail and slide over bracket body. **TIGHTEN ALL SCREWS**

- 14 SILICONE SEAL** unit to wall and bath.

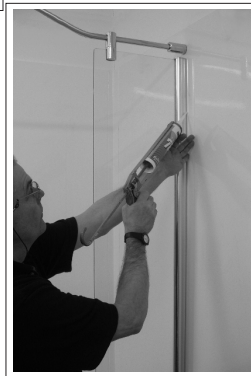

Seal wallpost to wall on inside & outside



Seal glass panel to bath on inside & outside.
Seal bottom of wallpost to bath on **outside only**.
Do not seal bottom of wallpost to bath on inside.

FITTING CURTAIN - not supplied - we recommend fitting 3 curtain rings to rail between top finial and wall to retain curtain in position.