

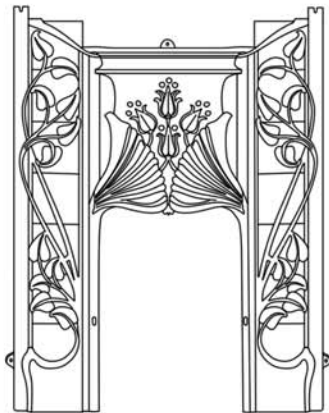

The Toulouse Combination

Contents



Fireplace Fascia

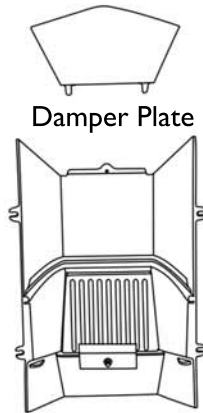

Fireplace Back

Shelf

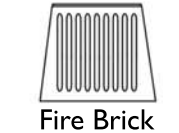

Fire Brick

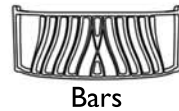

Bars



Grate



Ashpan Cover



Firebrick Retaining Plate



1x M6 Bolt



Ashpan Handle

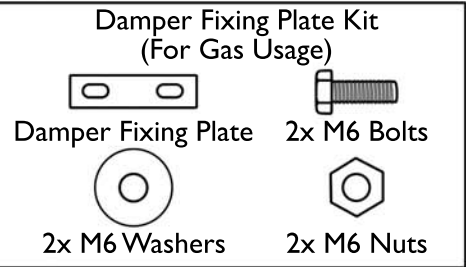

Damper Fixing Plate

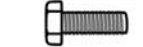

2x M6 Bolts



2x M6 Washers



2x M6 Nuts



7x M6 Grub



8x M6 Washer



7x M6 Nut



1x M6 Bolt

Please note, a flat head screwdriver and spanner are required to assemble this fireplace.

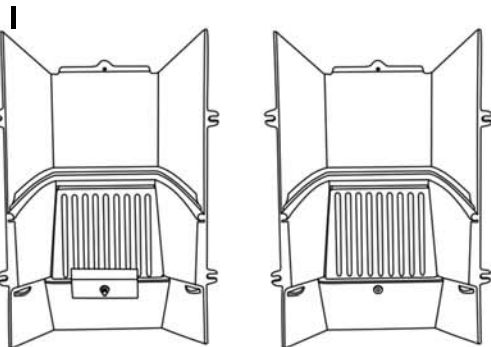

1 Remove the Firebrick Retaining Plate by removing the 1 x M6 Stud, Washer and Bolt.

THIS STEP IS NOT REQUIRED FOR SOLID FUEL USE

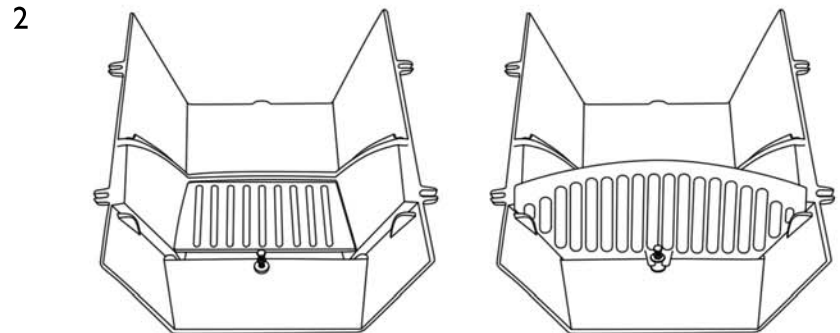

2 Lay Fireplace Back down on level ground. Position Firebrick in place and then insert 1 x M6 Bolt into the hole just below the Firebrick. Insert Grate into the groves on the Fireplace Back, passing the fixing lug over the M6 Stud. Secure in place with 1 x M6 Washer and 1 x M6 Bolt.

THIS STEP IS NOT REQUIRED FOR GAS USAGE.

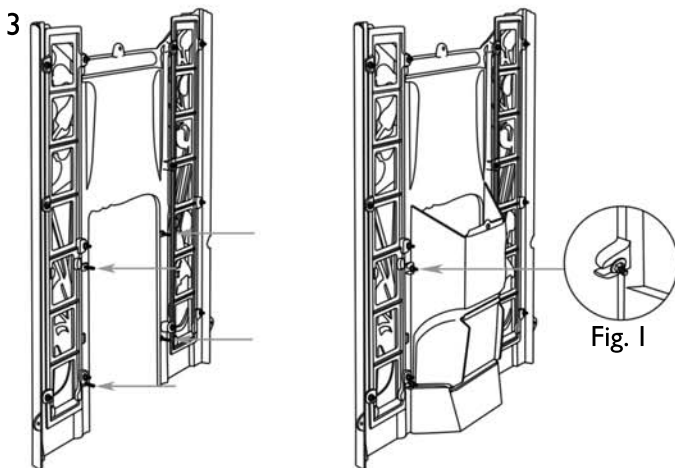

3 Insert the 4 M6 Studs into the back of the Fireplace Fascia. Attach Fireplace Back to the back of the Fireplace Fascia, ensuring that the M6 Studs pass through the fixing brackets on the Fireplace Back. Secure and tighten using 4 M6 Washers and 4 M6 Nuts.



Fig. 1

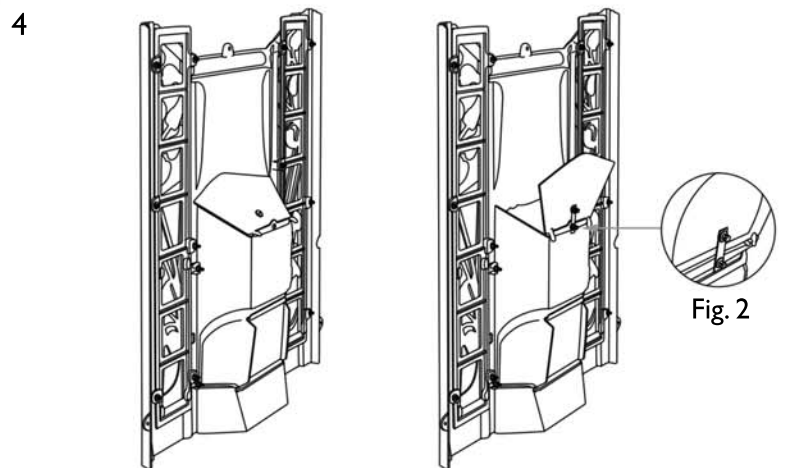

4 Solid Fuel Usage: Rest the Damper Plate onto the groove on the back of the Fireplace Fascia.

Gas Usage: The Damper Plate must remain fixed open for Gas Usage by using the Damper Plate fixing Kit. Screw M6 Nut fully onto M6 Bolt and lastly M6 washer x2. Attach Damper Fixing Plate as fig 2

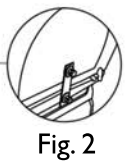
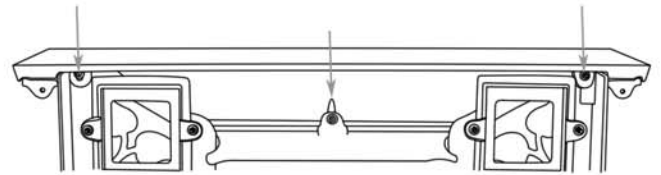
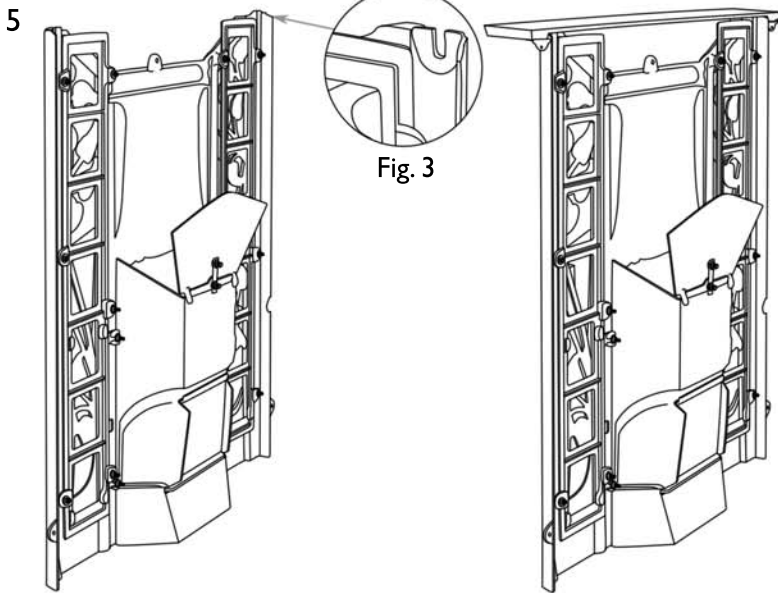

Fig. 2



The Toulouse Combination



Rear View with Shelf attached

Insert 2 M6 Studs into the left and right holes on the back of the Shelf, place a washer on each and loosely attach the nuts. Place the shelf onto the Fireplace Fascia ensuring that the 2 M6 Studs slot into the slots as Fig.3. Tighten the 2 Nuts on the left and right. Pass 1 M6 Stud through the center hole on the Fireplace Back, secure with an M6 Washer and Nut.

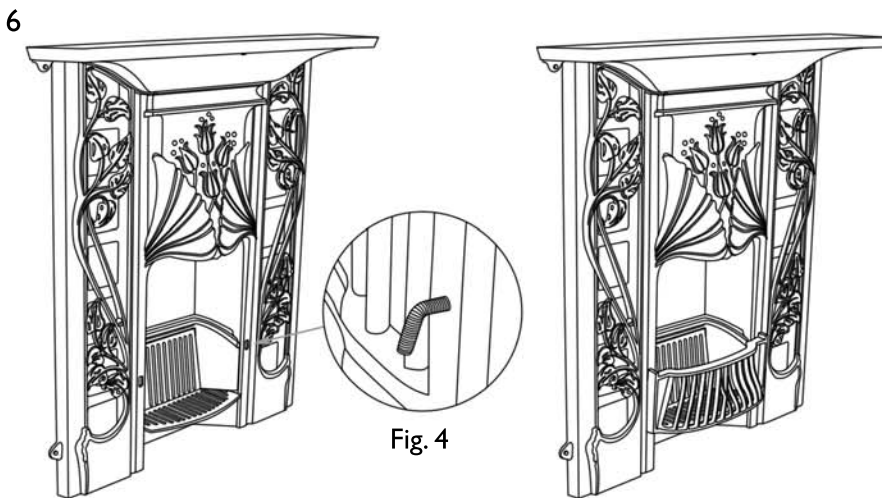

Attach the 2x Fixing Studs to the back of the Bars as Fig. 4. Attach Bars to the Fireplace Fascia, passing 2x Fixing Studs through the groves.

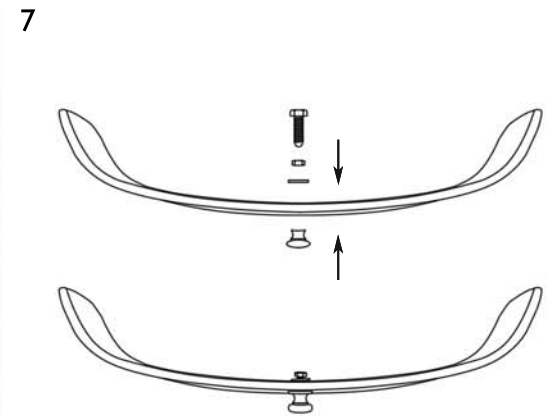

Attach the Ashpan Handle to the Ashpan using 1x M6 Bolt, 1x M6 Washer and 1x M6 Nut.

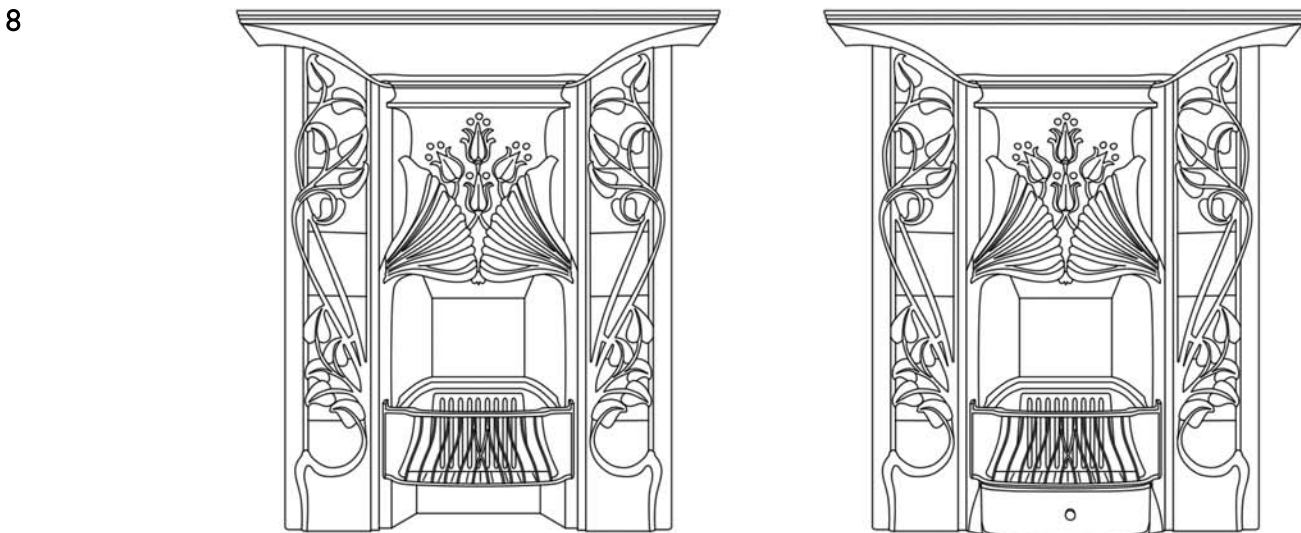

To complete, place Ashpan Cover below Grate and Bars on the front of the Fireplace.