

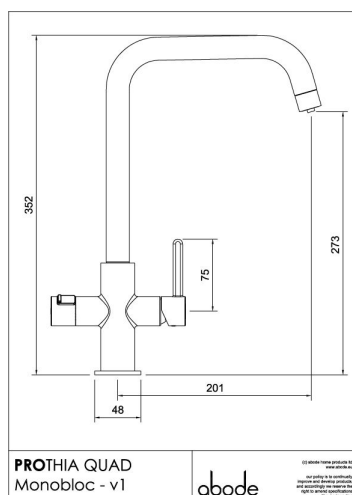

PRONTEAU tap features:

- Stylish 3 way mixer tap delivering domestic hot, cold and heated filtered water
- Slide and twist safety lock hot handle
- Contemporary slimline aesthetic
- Insulated 180° Swivel spout for maximum flexibility
- Scale inhibiting filter cartridge included
- 5 Year Warranty*
- WRAS approval pending



- **Overall Height / projection:** 352 mm
- **Exit spout reach:** 201 mm
- **Exit spout height:** 273 mm
- **Base diameter(s):** 48 mm
- **Recommended hole diameter:** Ø35 mm
- **Max. surface installation depth:** 50 mm
- 55mm from centre of tap hole to wall/backplash behind wall (Single lever handle rotates backwards 45°)

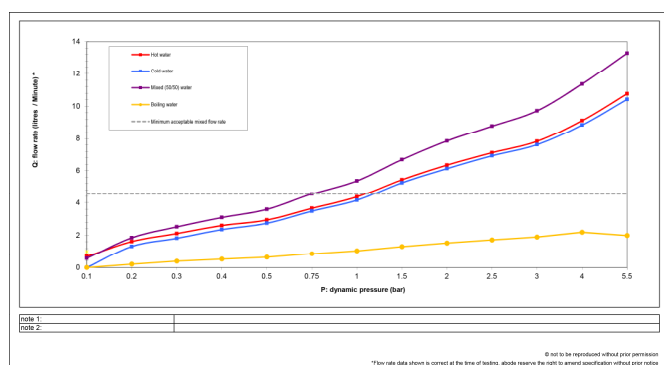

PRONTEAU flow information and connectivity:

- **Min cold water pressure requirement:** 1.5 bar
- **Min hot water pressure requirement:** 0.80 bar
- **Recommended / Maximum (domestic) hot water temperature:** 46°C / 70°C
- **Part G - Mixed flow rate at 3 bar (litres/min):** 9.10
- **Control valve type:** 1 x 1/2" Ceramic disc QT, 1 x Single lever 25mm
- **Product flow characteristics:** (H&C/Boiling) dual flow
- **Hot and Cold inlets:** Flexible hose connections supplied
- **Non return valve(s):** Yes, integral to cold inlet flexi hose only

Care instructions and Warranty Summary*

- Clean the tap regularly as required, using a mild soap and damp cloth, do not use any other cleaners, regular cleaning will prevent the build-up of lime scale and dirt
- Maintain the heater according to the user guide, for example replace filter and descale when required.

- Mixertap materials and workmanship defects warranted for 5 years
- Proboil2X materials and workmanship defects warranted for 2 years
- Mixertap valves and working parts warranted for 5 years
- Surface finish warranty defects warranted for 1 year
- All o-rings, hoses & gaskets warranted for 1 year



PROBOIL.2X features:

- Controllable tank temperature range from 75°C (holiday/eco mode) to 85,90,95,96, 97, 98°C using the touch screen controls.
- 2.1 Litre capacity tank, apx. 7 minutes reboil after use
- On screen filter life / replacement indicator
- Intelligent self-diagnostic control
- No external drain connection needed for a simplified and more flexible installation
- Flow limited to 2 litres/min to limit splashing and ensure a smooth flow
- Tool free, hand tight connectors to speed up installation, maintenance and descaling
- Compact size 22x22x28cm
- 2 Year Warranty*
- WRAS approval pending

All temperatures quoted are measured within the tank of the boiler and actual spout exit temperature may vary dependant on local conditions and tap model.

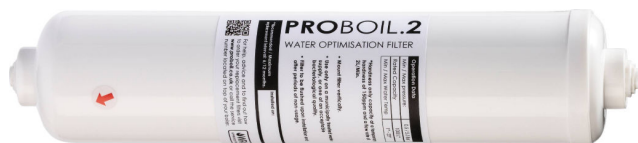

PROBOIL.2 filter features:

- Filtered 98°C drinking water, engineered specifically for hot water applications
- Included with every **PROBOIL.2X** system
- Recommended replacement interval 6 months
- Chlorine taste and odour reduction
- Scale reduction for better drinks and tank protection
- WRAS approved



The complete package:

Each **PRONTEAU** system includes:

- A stylish choice of **PRONTEAU** mixer taps
- **PROBOIL.2X** hot water boiler
- **PROBOIL.2** scale control filter & assembly
- Comprehensive user and installation guide
- Nationwide professional maintenance and service support