



PRCH301

**Manual for Installation, Use and Maintenance
Ceiling Cooker Hood**

Important

The manufacturer cannot be held responsible for injuries or losses caused by incorrect use or installation of this product. Please note that the manufacturer reserves the right to invalidate the guarantee supplied with this product following incorrect installation or misuse of the appliance or use in a commercial environment.

This appliance is not designed to be used by people (including children) with reduced physical, sensorial or mental capacity, or who lack experience or knowledge about it, unless they have had supervision or instructions on how to use the appliance by someone who is responsible for their safety.

Under no circumstances should any external covers be removed for servicing or maintenance, except by suitably qualified personnel.

Two people are needed for installation of this product.

Appliance information:

Please enter the details on the appliance rating plate below for reference, to assist Customer Care in the event of a fault with your appliance and to register your appliance for guarantee purposes.

Appliance Model

Serial Number

CE Declarations of Conformity:

This appliance has been manufactured to the strictest standards and complies with all applicable legislation, including Gas safety, Electrical safety (LVD) and Electromagnetic interference compatibility.

IMPORTANT INFORMATION FOR THE CORRECT DISPOSAL OF THE PRODUCT, IN ACCORDANCE WITH EC DIRECTIVE 2002/96/EC.

At the end of its working life, the product must be taken to a special local authority waste collection centre or to a dealer providing appliance recycling services. Disposing of a household appliance separately avoids possible negative consequences for the environment and health. It also enables the constituent materials to be recovered, saving both energy and resources.

As a reminder of the need to dispose of household appliances separately, the product is marked with a crossed-out wheeled dustbin.

Please note:

- Under no circumstances should the extractor be connected to any gas ventilation system, flue system or hot air ducting system.
- Do not vent the extractor into an attic or loft space.
- Only house the extractor in rooms with adequate ventilation. Remember that the extractor is powerful and whatever air is extracted needs to be replaced.
- You must be able to isolate the extractor from the mains electrical supply after installation.
- Steam cleaners must not be used when cleaning this appliance.
- The performance of your extractor will vary depending on a number of factors. These include: type of extraction, length of ducting, room volume, ventilation available and cleanliness of the filters.

INSTALLATION

Cut holes in the ceiling.

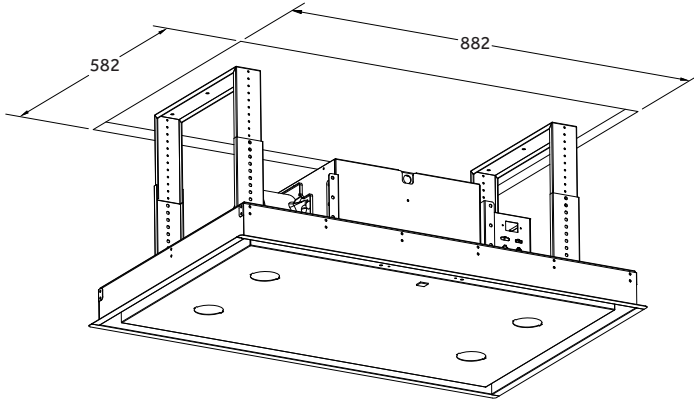

Fig.1

Drill holes in the ceiling according to the size of the hanging holes of the rack with $\phi 10$ Drill.

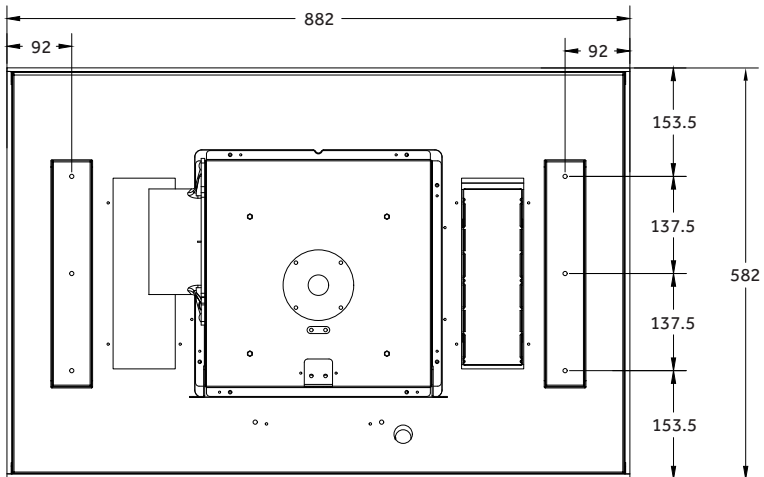

Fig.2

Fix the upper rack with 6 sets of expansion bolts.

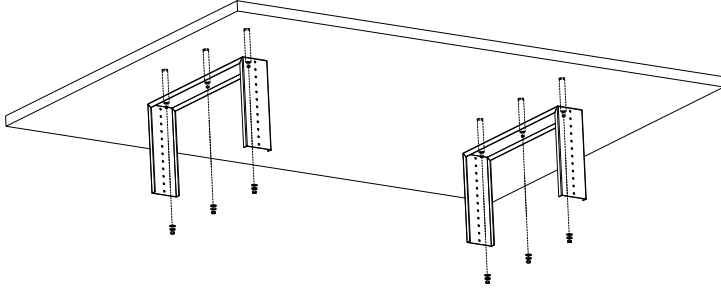

Fig.3

Fasten the lower bracket with the upper bracket with 8 units M4*10 Screws.

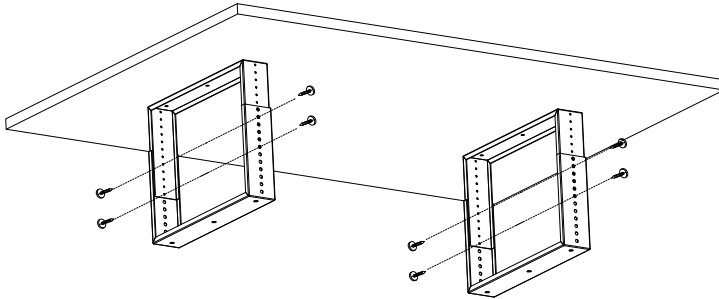

Fig.4

Fix the air outlet to the machine with 4 ST4*10 screws.

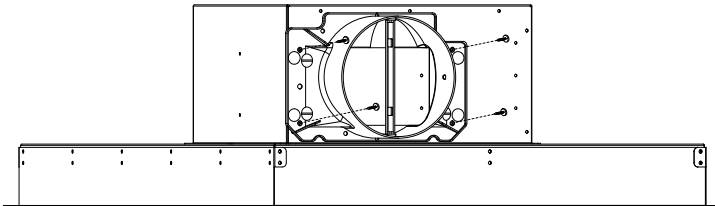

Fig.5

Put the whole machine in the ceiling opening.

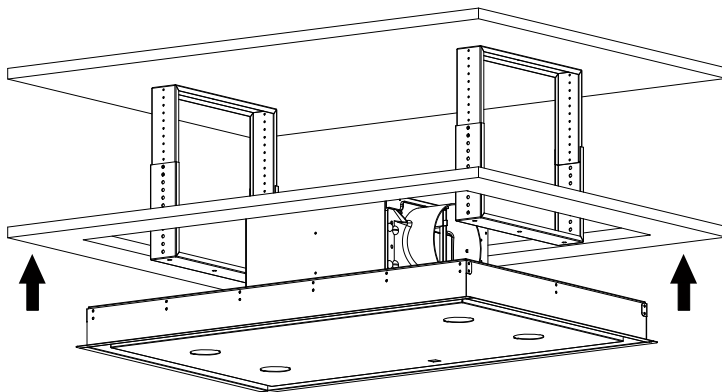

Fig.6

Fix the whole machine to the rack with 6 M5*40 screws and washers.

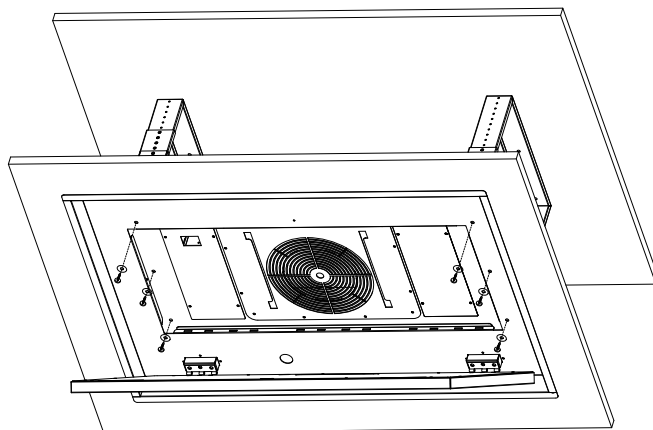

Fig.7

Split installation method

Remove the 8 screws from fixing the bellows of the whole machine, and detach the bellows from the body.

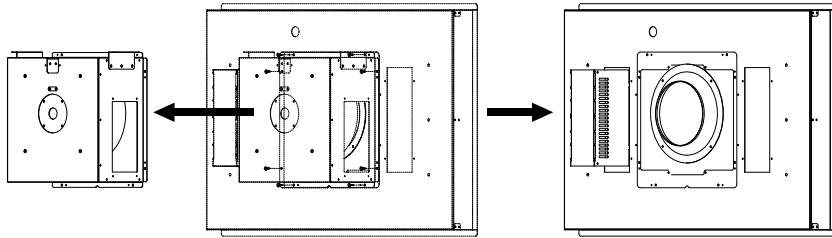

Fig.8

Remove the four screws that fix the front panel on the housing and remove the front panel.

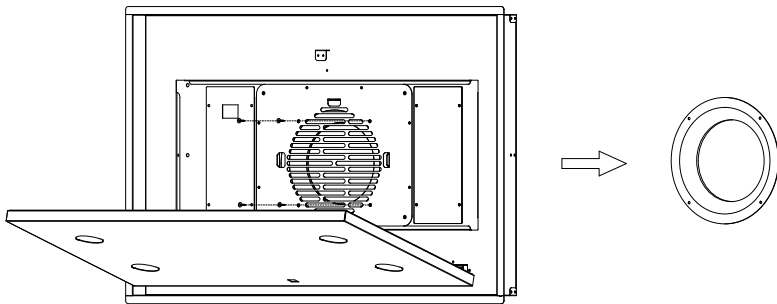

Fig.9

Put the air outlet claw into the cover gap, and rotate the air outlet with force to install the air outlet and the cover together (two sets in total).

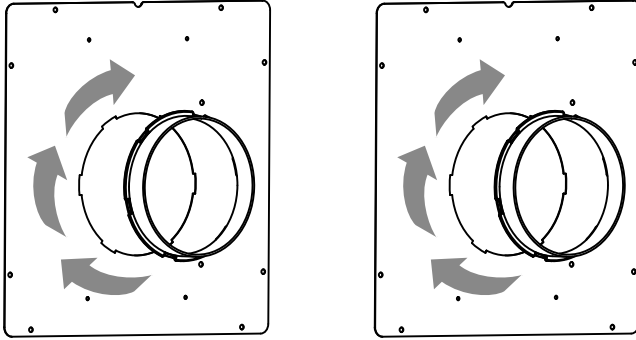

Fig.10

Fix the front panel with screws to the cover of the accessory windbox; note that the front panel is fixed to the side opposite to the air outlet.

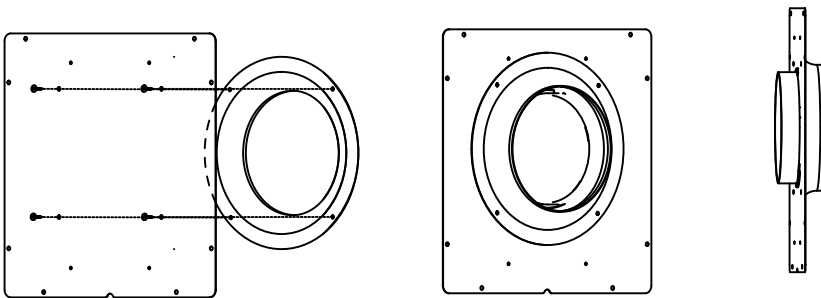

Fig.11

Fix the cover of the wind box with the wind cutter to the wind box with 8 M4 screws; Note: The side with the wind cutter is facing the motor.

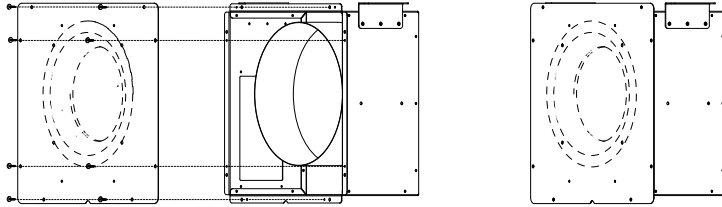

Fig.12

Put another ducting cover instead to the case with 8 M4 * 8 screws.

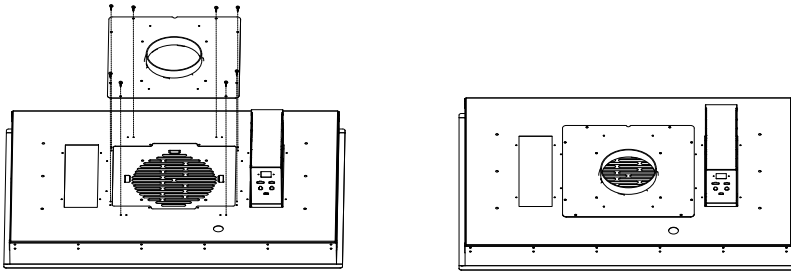

Fig.13

Fix the housing assembly in place according to the integral suspension method.

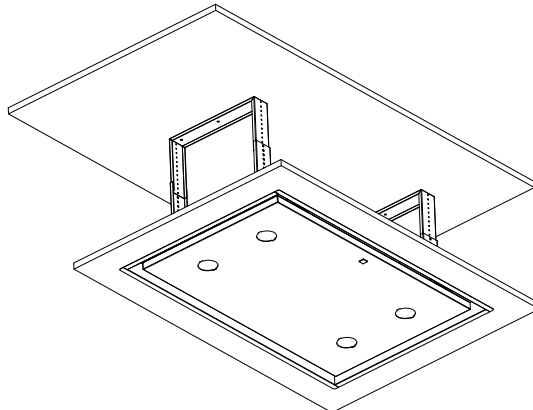

Fig.14

Make 4 holes in the ceiling with $\phi 8$ drill.

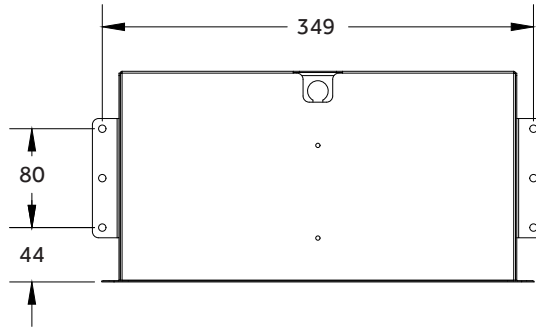

Fig.15

Fix the bellows assembly in place with 4 units 4 * 35 screws and expansion bolts.

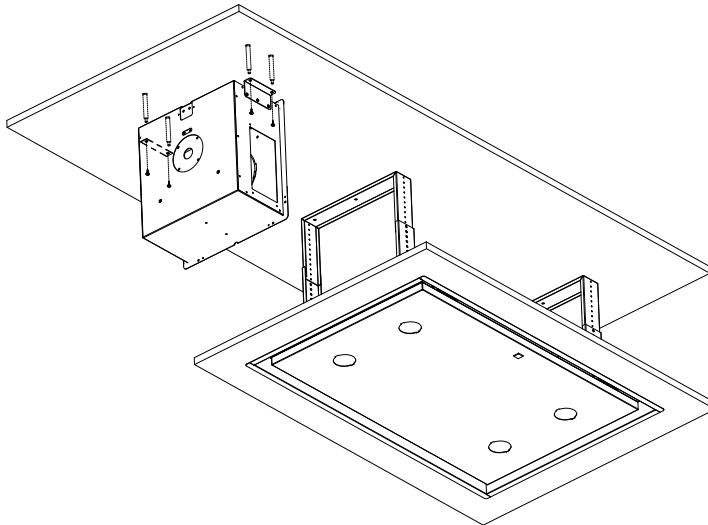

Fig.16

Fix the air outlet to the air box with 4 ST4*10 screws.

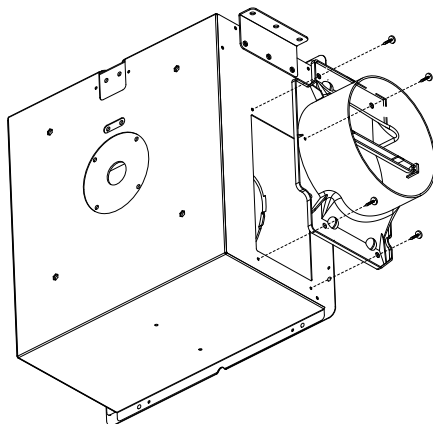

Fig.17

Connect the bellows to the housing with a $\phi 150$ hose.

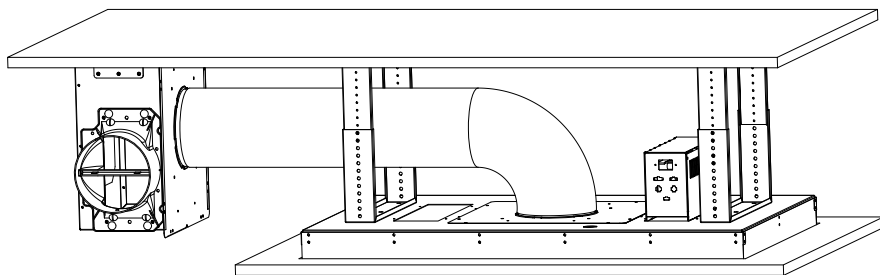

Fig.18

MAINS ELECTRICITY CONNECTION

-**This appliance is intended to be connected to the mains electrical supply by means of an isolation switch and fused spur and it is intended to be protected by a 3A fuse.** The use of a 13A fuse can cause damage to the internal wiring in the event of a fault and may also invalidate the warranty.

-**Assembly and electrical connection should be carried out by qualified personnel.** We recommend that the appliance is connected by a fully qualified electrician who is a member of the N.I.C.E.I.C and who will comply with the I.E.T and local regulations.

-**Do not mount the isolation switch so that it cannot be accessed.** It is a requirement that you must be able to isolate the extractor from the mains electrical supply after installation is complete.

-The wires in the power cord for this appliance are coloured in accordance with the following code:

- I. Green/Yellow – Earth
- II. Blue – Neutral
- III. Brown – Live

-The wire which is coloured green and yellow must be connected to the terminal marked **E (Earth) or coloured green.**

-The wire which is coloured blue must be connected to the terminal marked **N (Neutral) or coloured black.**

-The wire which is coloured brown must be connected to the terminal marked **L (Live) or coloured red.**

DOUBLE POLE SWITCHED FUSE SPUR OUTLET

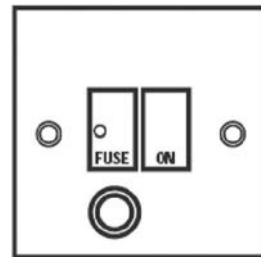

USE A 3 AMP FUSE

USING YOUR EXTRACTOR

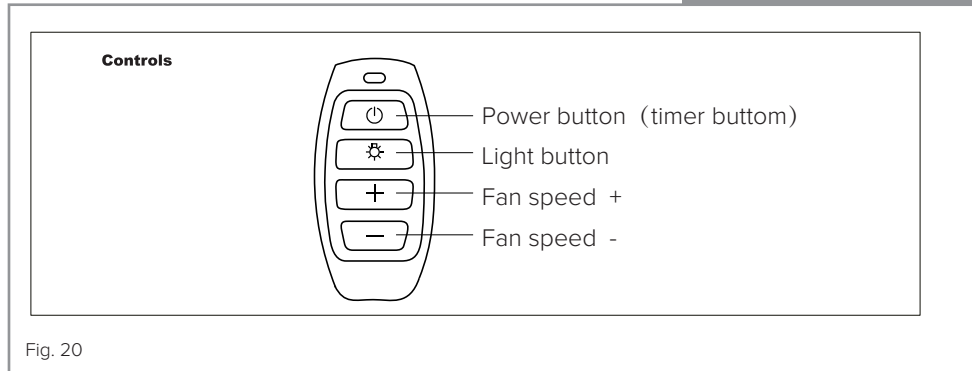

Remark: How to get matching by light button, long press light button for 2 seconds, the remote control with extractor switch can be matched.

1. Power button:

Power button: Press the button, the extractor starts working at speed 1, digital display show "1" press again, the speed will be off and the display will be off.

Long Press the power button in 2 seconds at any speed,(except booster speed), it goes into timer function, the display is flashing, within the timer function, the speed can be adjusted. When the speed goes into off, the timer will be off.

2. Light button, switch on /off the light.

3. Speed button+ :

When the working speed at 1, press the button,it comes to speed 2, press again and again, the speed comes to speed 3, booster, off and 1,2,3, booster...

4. Speed button - : when the working speed is at 1, press the button,it switches off, press again and again, the speed come to speed booster,3,2,1... The booster speed, works for 5 minutes before automatically dropping to speed 3.

TROUBLESHOOTING

YOU OBSERVE THAT	POSSIBLE CAUSES	WHAT SHOULD YOU DO?
THE HOOD DOES NOT WORK	<ul style="list-style-type: none">-THERE IS A POWER OUTAGE.-WIRE CONNECTORS ARE FAULTY OR HAVE DISCONNECTED.	<ul style="list-style-type: none">-CHECK POWER SUPPLY.-CHECK ORIENTATION AND SECURITY OF CONNECTORS.
THE OUTPUT IS LOW	<ul style="list-style-type: none">-SETTING IS INSUFFICIENT FOR FUMES PRESENT.-INADEQUATE VENTILATION IN KITCHEN.-CHARCOAL FILTER (IF FITTED) IS BLOCKED.-EXIT DUCTING IS OBSTRUCTED.-EXIT FLAPS ON MOTOR HOUSING ARE RESTRICTED.	<ul style="list-style-type: none">-TRY A MORE POWERFUL SPEED SETTING.-ENSURE ADEQUATE AIR INTAKE INTO KITCHEN.-REPLACE CHARCOAL FILTER.-REMOVE ANY OBSTRUCTIONS FROM DUCTING.ENSURE FLAPS CAN MOVE FREELY.
THE HOOD STOPS MID OPERATION	<ul style="list-style-type: none">-THERE IS A POWER OUTAGE.-THE CIRCUIT BREAKER OR FUSE HAS TRIPPED.	<ul style="list-style-type: none">-CHECK THE POWER SUPPLY.-CHECK CIRCUIT BREAKER OR FUSE.



GUARANTEE

Your new product is guaranteed against defects in materials and/or workmanship. Any parts found to be defective will be repaired or replaced at our discretion. All repairs must be carried out by an authorised Repair Agent. Your extractor comes with a 5 years Parts 2 years Labour Guarantee if registered within 30 days of purchase.

THIS GUARANTEE IS VALID PROVIDING THAT :

- The appliance has been installed by a suitably qualified person
- Installation has been carried out in accordance with instructions and current legislation
- Proof of purchase can be produced
- The appliance has been used for domestic purposes only
- The appliance has not been tampered with or repair attempted or modified by any unauthorised person

THIS GUARANTEE DOES NOT COVER :

- Damage by misuse, neglect or transit
- Use of parts that have not been recommended
- Routine maintenance, general wear & tear and installation faults
- Rubber seals, removable glass and/or plastic parts, fuses or light bulbs which all need replacing periodically
- Second-hand or reconditioned appliances
- Appliances used for commercial or professional purposes

This guarantee does not in any way affect your statutory legal rights.

Attribute	Symbol	Value	Units
Model Identification		PRCH301	
Annual Energy Consumption	AEC_{Hood}	68.8	kWh
Time Increase factor	f	1.0	
Fluid Dynamic Efficiency	FDE_{Hood}	27.1	
Energy Efficiency Index	EEl_{Hood}	62.6	
Measured Airflow at Best Efficiency Point	Q_{BEP}	378.8	m ³ /h
Measured Pressure at Best Efficiency Point	P_{BEP}	423	Pa
Maximum Airflow	Q_{MAX}	675.0	m ³ /h
Measured Electric Power at Best Efficiency Point	W_{BEP}	164.5	W
Nominal Lighting Power	WL	7.3	W
Average Illumination of the lighting system on the cooking surface	E_{Middle}	677	Lux
Measured Power Consumption in standby	P_s	/	W
Measured Power Consumption off mode	P_o	0.46	W
Noise Level	L_{WA}	74	dBA
Grease Filter Efficiency	GFE_{Hood}	46.6 (F)	%
Lamp Efficiency	LE_{Hood}	92.7 (A)	%

E & O E. All instructions, dimensions and illustrations are provided for guidance only. Prima reserve the right to change specifications without prior notice.



Please call **PRIMA CARE** for Service;
Contact number: 0344 576 6841
Website: www.prima-appliances.uk/primacare