

# Technical Data Sheet

# ROPER RHODES®

## CASE DOUBLE SHOWER BOTTLE BASKET

Whats in the box: 1x DB80.02 & Fixings

Diagrams not to scale  
All dimensions in mm  
tolerance of +/-5mm

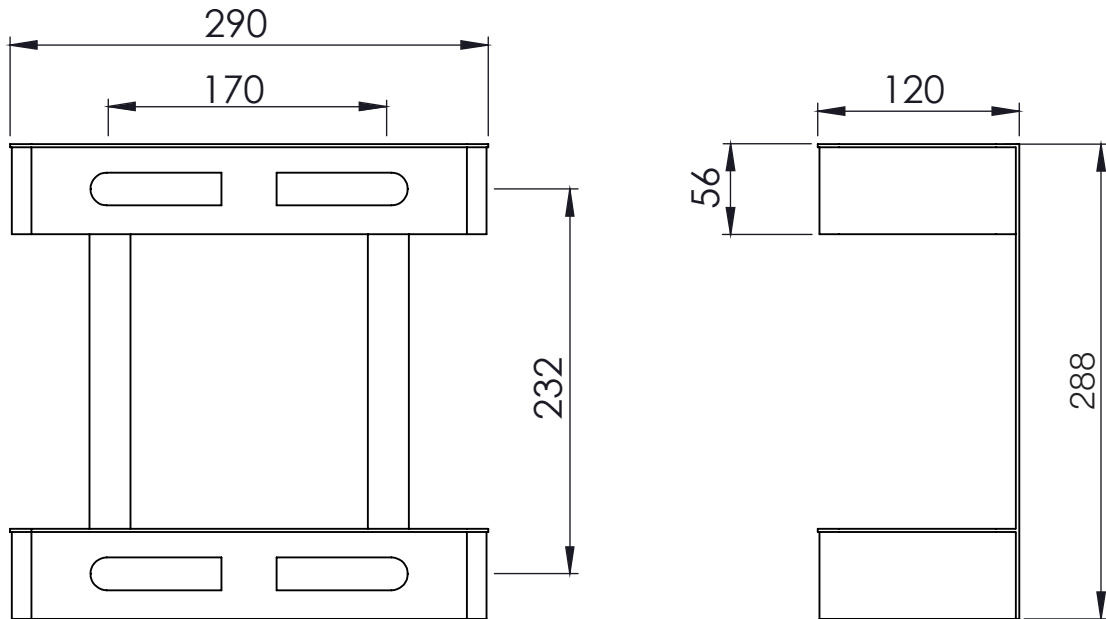

### Materials

Frame: Chrome plated brass

Basket: White ABS

\*\*Dimensions are subject to change, customers are advised to measure actual product before commencing installation.

\*\*\*Fixing point dimensions are for guidance only/the positions of wall fixing must be checked when product is received.

### FAQs

- |  |   |
|--|---|
| Q: What is the overall distance from the wall? | A: 120mm  |
| Q: Fixing point centres?                       | A: 170mm  |
| Q: Distance between both brackets?             | A: 232mm  |
| Q: Internal height between the baskets?        | A: 213mm  |
| Q: Is the inner basket removable?              | A: Yes, you can remove the inner for easy cleaning. |