

PRODUCT DATA SHEET



PRODUCT CODE
TL112DNST

RANGE
3ONE6 Lever

DESCRIPTION
3ONE6 Lever Basin Tall Mono Stainless
Slate

WEBSITE LINK [Click Here](#)

| | |
|-----------------------|---------------------|
| CATEGORY | Brassware |
| WARRANTY DETAILS | 15 Years |
| COLOUR | Slate |
| FINISH APPLICATION | PVD |
| PRIMARY MATERIAL | 316 Stainless Steel |
| INSTALL TYPE | Deck Mounted |
| PRODUCT WIDTH MM | 45 |
| PRODUCT HEIGHT MM | 317 |
| PRODUCT NET WEIGHT KG | 1.35 |
| STANDARDS | BS EN 817:2008 |

| | |
|------------------------------------|-------------------------------------|
| MINIMUM PRESSURE (BAR) | 1 |
| MAX WORKING PRESSURE (BAR) | 5 |
| NUMBER OF OUTLETS | 1 |
| NUMBER OF FUNCTIONS | 1 |
| HEADWORK | 25mm Single lever ceramic cartridge |
| SPOUT PROJECTION | 190 |
| SWIVEL SPOUT | No |
| INLET CONNECTIONS THREAD | G1/2" |
| OUTLET CONNECTIONS THREAD | M16.5x1 |
| FLOW REGULATOR | Cache M16.5x1 |
| WASTE INCLUDED | No |
| ANTI-SCALD | No |
| ENERGY SAVING | No |
| SHOWER HOSE & HANDSET ARE INCLUDED | No |

| | | | | | | | |
|---------------------|-----|-----|------|------|------|------|------|
| PRESSURE (BAR) | 0.2 | 0.5 | 1 | 2 | 3 | 4 | 5 |
| PRIMARY FLOWRATE | | | 2.57 | 3.81 | 4.68 | 5.28 | 5.75 |
| HANDSET FLOWRATE | | | | | | | |
| MESSAGE FLOW RATE | | | | | | | |
| AIR FLOW RATE | | | | | | | |
| WIRE FLOW RATE | | | | | | | |
| WATERFALL FLOW RATE | | | | | | | |
| MIST FLOW RATE | | | | | | | |
| HANDSPRAY FLOW RATE | | | | | | | |

TECHNICAL DIMENSIONS

Dimensions in mm unless otherwise specified.

Tolerances (per material type) apply.

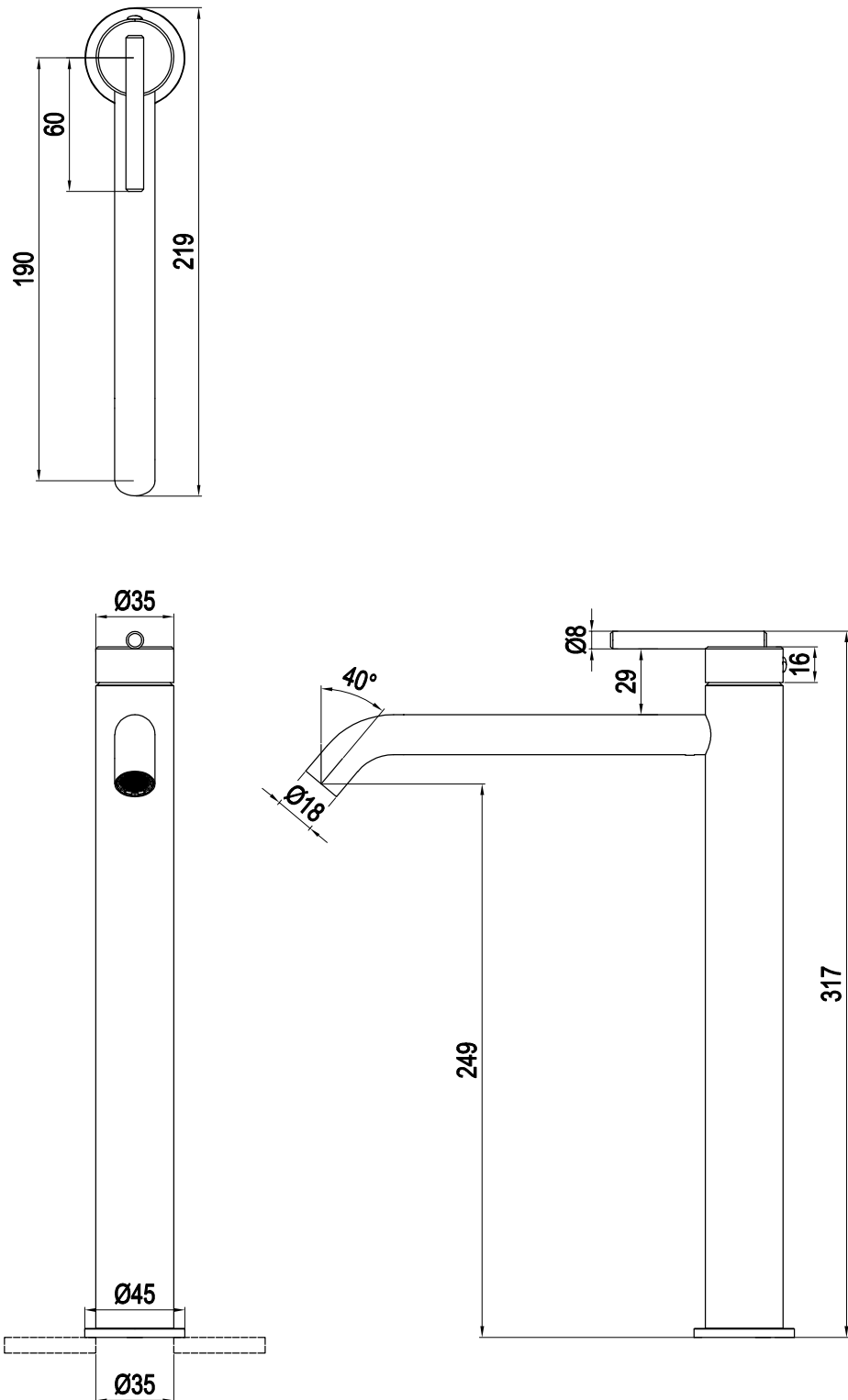

SPARES LIST

Only the parts labelled are available as spares.

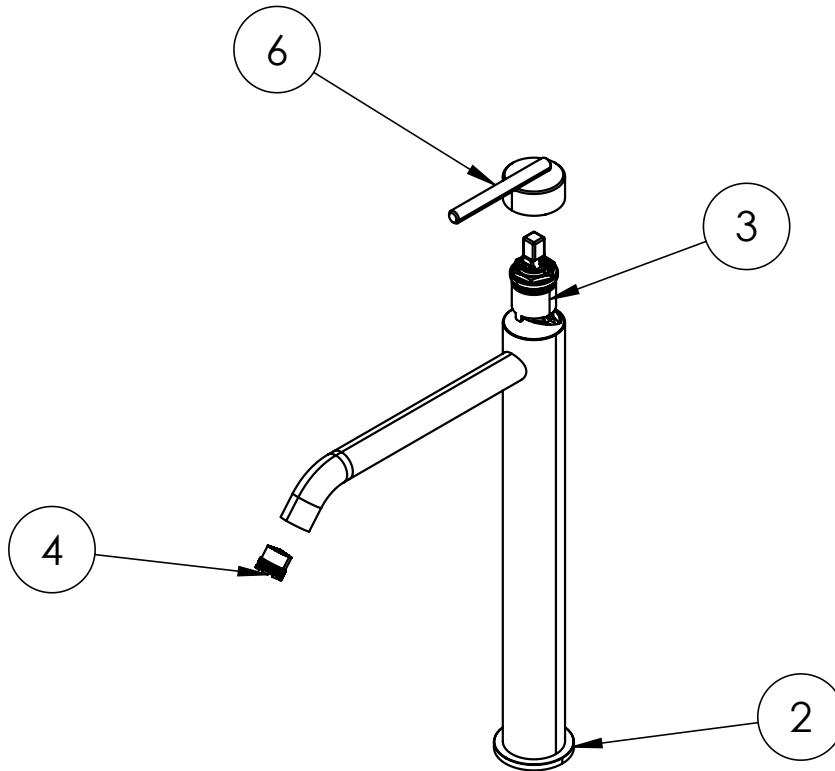

| NUMBER | PART CODE | DESCRIPTION |
|--------|--------------|---|
| 1 | B19002200-YY | Glide & 3ONE6 112 Flexible Hose |
| 2 | A060111002 | TS110/112DNST Base Ring |
| | A060111001 | TS110/112DNSF Base Ring |
| | A060111000 | TS110_112DNS Base Ring |
| 3 | A060110700 | TS110_112DNS Cartridge |
| 4 | A060110800 | 3ONE6 Basin Aerator |
| 5 | B14001400 | TS112DNS/F/T Fixing Kit |
| 6 | A065110300 | TL110DNS/TL112DNS/TL114DNS/TL111DNS/TL113DNS Lever |
| | A065110301 | TL110DNSF/TL112DNSF/TL114DNSF/TL111DNSF/TL113DNSF Lever |
| | A065110302 | TL110DNST/TL112DNST/TL114DNST/TL111DNST/TL113DNST Lever |