

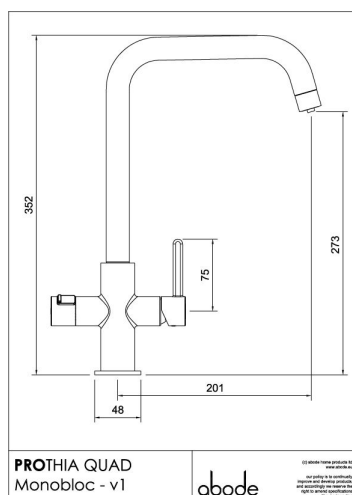

## PRONTEAU tap features:

- Stylish 3 way mixer tap delivering domestic hot, cold and heated filtered water
- Slide and twist safety lock hot handle
- Contemporary slimline aesthetic
- Insulated 180° Swivel spout for maximum flexibility
- Scale inhibiting filter cartridge included
- 5 Year Warranty\*
- WRAS approval pending



- **Overall Height / projection:** 352 mm
- **Exit spout reach:** 201 mm
- **Exit spout height:** 273 mm
- **Base diameter(s):** 48 mm
- **Recommended hole diameter:** Ø35 mm
- **Max. surface installation depth:** 50 mm
- 55mm from centre of tap hole to wall/backplash behind wall (Single lever handle rotates backwards 45°)

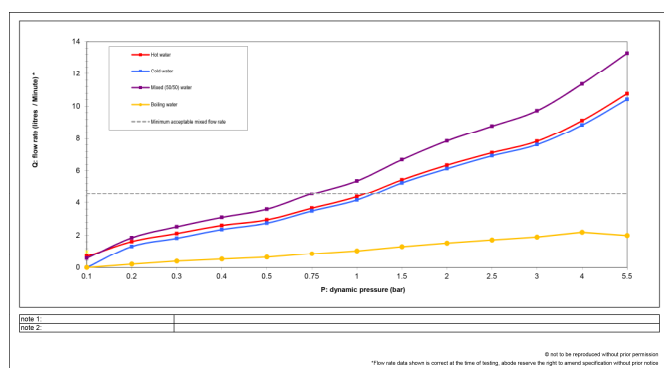

## PRONTEAU flow information and connectivity:

- **Min cold water pressure requirement:** 1.5 bar
- **Min hot water pressure requirement:** 0.80 bar
- **Recommended / Maximum (domestic) hot water temperature:** 46°C / 70°C
- **Part G - Mixed flow rate at 3 bar (litres/min):** 9.10
- **Control valve type:** 1 x 1/2" Ceramic disc QT, 1 x Single lever 25mm
- **Product flow characteristics:** (H&C/Boiling) dual flow
- **Hot and Cold inlets:** Flexible hose connections supplied
- **Non return valve(s):** Yes, integral to cold inlet flexi hose only

## Care instructions and Warranty Summary\*

- Clean the tap regularly as required, using a mild soap and damp cloth, do not use any other cleaners, regular cleaning will prevent the build-up of lime scale and dirt
- Maintain the heater according to the user guide, for example replace filter and descale when required.

- Mixertap materials and workmanship defects warranted for 5 years
- Proboil2X materials and workmanship defects warranted for 2 years
- Mixertap valves and working parts warranted for 5 years
- Surface finish warranty defects warranted for 1 year
- All o-rings, hoses & gaskets warranted for 1 year



All temperatures quoted are measured within the tank of the boiler and actual spout exit temperature may vary dependant on local conditions and tap model.

#### PROBOIL.2X features:

- Controllable tank temperature range from 75°C (holiday/eco mode) to 85,90,95,96, 97, 98°C using the touch screen controls.
- 2.1 Litre capacity tank, apx. 7 minutes reboil after use
- On screen filter life / replacement indicator
- Intelligent self-diagnostic control
- No external drain connection needed for a simplified and more flexible installation
- Flow limited to 2 litres/min to limit splashing and ensure a smooth flow
- Tool free, hand tight connectors to speed up installation, maintenance and descaling
- Compact size 22x22x28cm
- 2 Year Warranty\*
- WRAS approval pending

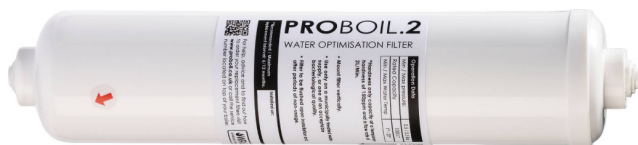

#### PROBOIL.2 filter features:

- Filtered 98°C drinking water, engineered specifically for hot water applications
- Included with every **PROBOIL.2X** system
- Recommended replacement interval 6 months
- Chlorine taste and odour reduction
- Scale reduction for better drinks and tank protection
- WRAS approved



#### The complete package:

Each **PRONTEAU** system includes:

- A stylish choice of **PRONTEAU** mixer taps
- **PROBOIL.2X** hot water boiler
- **PROBOIL.2** scale control filter & assembly
- Comprehensive user and installation guide
- Nationwide professional maintenance and service support