

Technical Data Sheet

ROPER RHODES®

ACADEMY 1000mm Floor Mounted Unit

Whats in the box: 1x ACY10F.X

*Reference basin TDS for further info

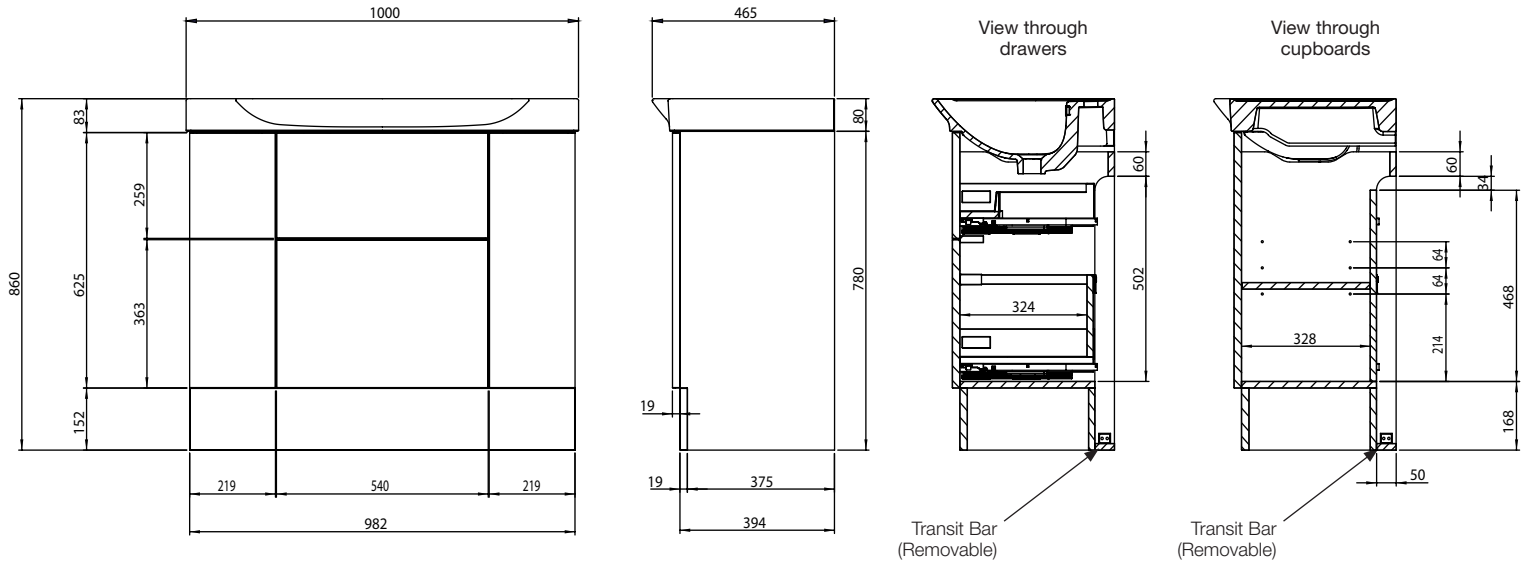

Diagrams not to scale
All dimensions in mm
tolerance of +/-5mm

Materials

Carcass: 16/18mm Painted & Melamine faced MDF
Fascia Components: 19mm Painted MDF

**Dimensions are subject to change, customers are advised to measure actual product before commencing installation.
***Fixing point dimensions are for guidance only/the positions of wall fixing must be checked when product is received.

Extra Dimensions

Internal Drawer Depth - Front to Back:	324mm
Internal Drawer Height:	69mm (Top) 201mm (Bottom)
Internal Drawer Width:	483mm
Drawer Cut Out (W&D):	170mm x 231mm

FAQs

Q: How big is the plumbing void?	A: 50mm
Q: How far apart are the hole centres for the handles?	A: N/A
Q: Are the handles fitted?	A: No, holes need drilling. Please refer to handle template provided.
Q: Are the runners soft close?	A: The runners are both soft close and quick release.
Q: How deep is the unit when the drawers are fully open?	A: Approx: 750mm.
Q: Can the drawers be adjusted?	A: The drawers can be adjusted as detailed in the supplied instructions.
Q: What is the door opening angle?	A: 90°
Q: What is the interior finish of the unit?	A: The unit interior finish is dark grey except for the side panels which match the exterior finish.
Q: Can I remove the transit bar at the bottom of the unit?	A: Yes, this should be removed on installation.
Q: Are the shelves adjustable in cupboards on both sides?	A: Yes
Q: What drawer does the rubber matting come in? Size?	A: Top drawer only. 483mm x 322mm with central cut for U Cut Out

NOTE: Colours unique to Roper Rhodes - No RAL Code available